

# Engineer-Class Sprocket Request Form



**Roller Chain  
& Sprockets**

(407) 347-3519 • sales@usarollerchain.com

**Chain Size/ Part #:** \_\_\_\_\_

**Note:** If you are unable to identify your chain or need assistance doing so, contact our customer service team for assistance.

**Outside Diameter (O.D.):**

**O.D.**

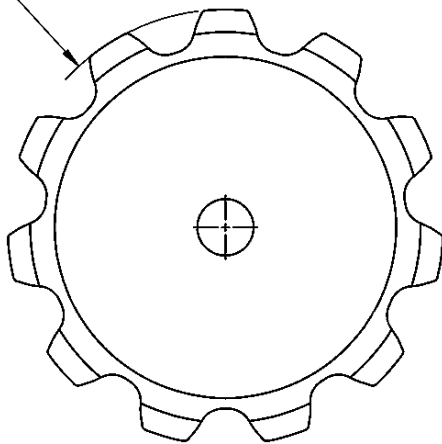

**Hub Type (A, B, C):** \_\_\_\_\_

**A-Plate**



**B-Hub**

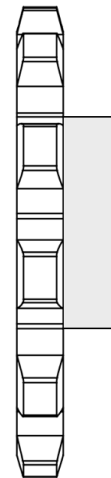

**C-Hub**

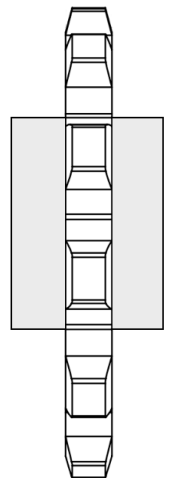

**Tooth Count:** \_\_\_\_\_

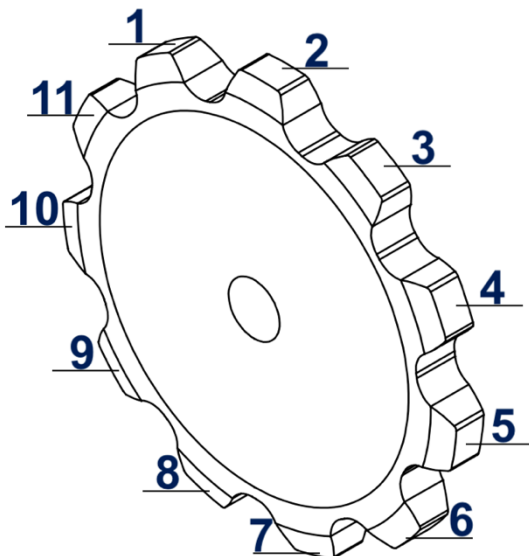

**Thickness:** \_\_\_\_\_

**Length Through Bore  
(L.T.B.):** \_\_\_\_\_

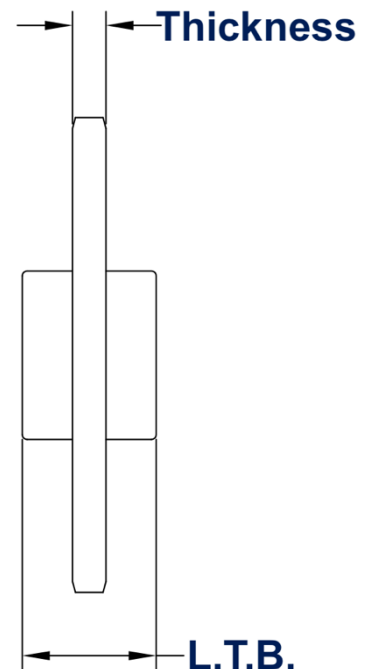

**Bore Configuration:** \_\_\_\_\_

**Notes:**

- Finished bore sprockets are supplied with a keyway and (2) set screws.
- Stock bore sprockets are supplied with a plain hole with no keyway or set screws.
- Idler bore sprockets are supplied with a bushing made from bronze or polymer, or with a bearing (please specify when requesting).

**Finished Bore**

**Plain Bore**

**Idler Bore**

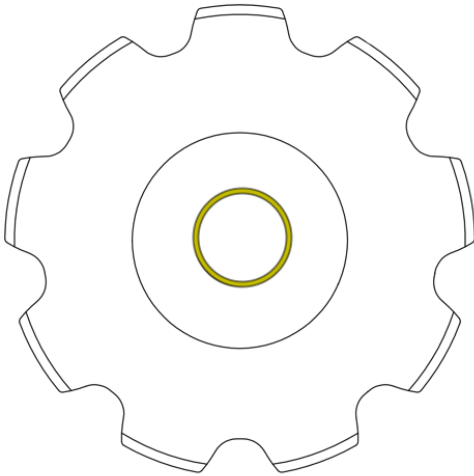
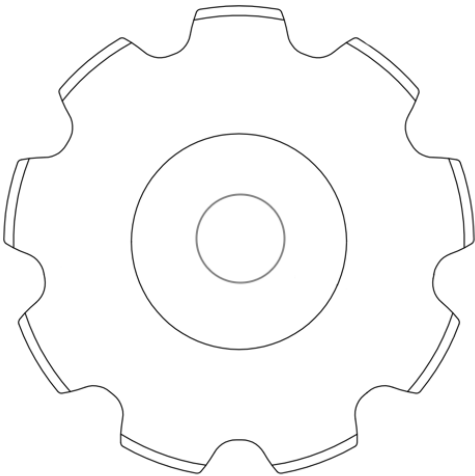
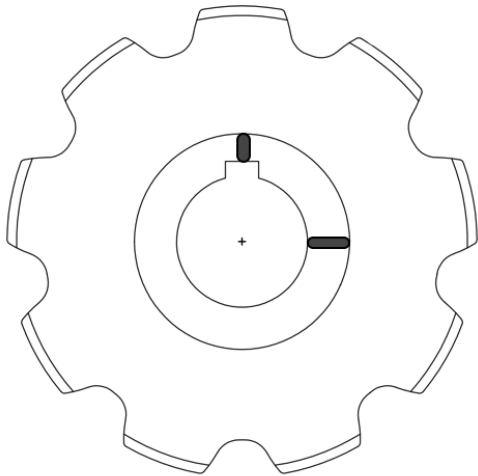

**Bore Size (Dimension B):** \_\_\_\_\_

**Keyway Dimensions \*Finished Bore Only\* (Width & Height):** \_\_\_\_\_

**Note:** Standard keyway size and set screw sizes will be supplied unless otherwise specified.

**Key**

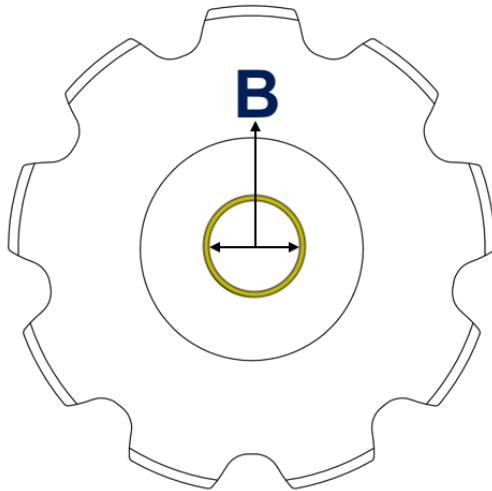
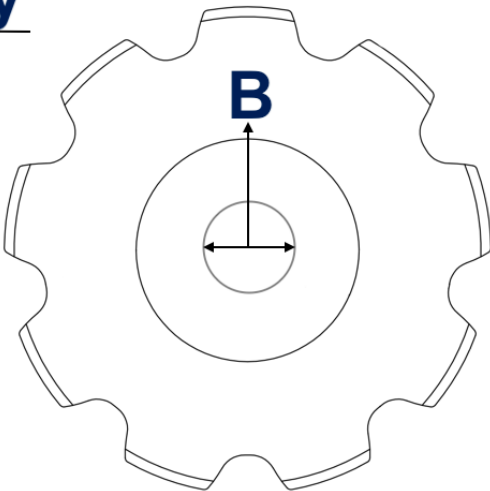
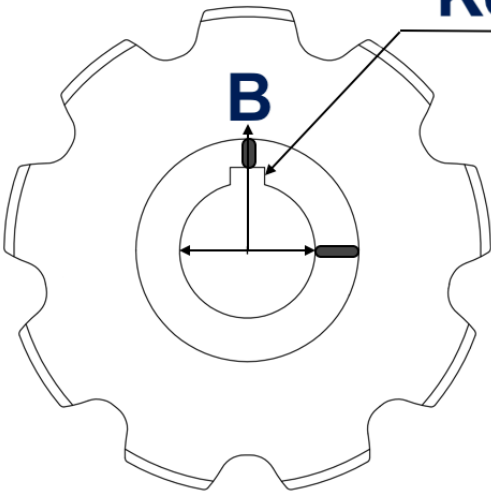

Sprocket Construction: \_\_\_\_\_

Notes:

- Solid construction is designed with no split.
- Split construction utilizes through-bolts, and the sprocket is a two-piece construction.

Split

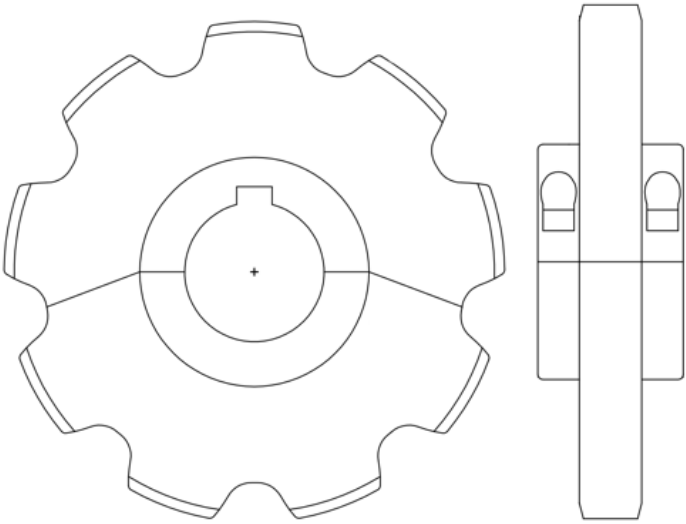

Solid

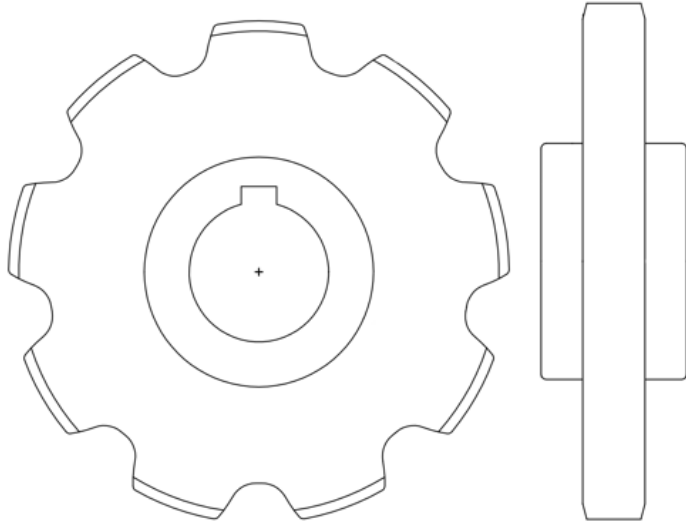

Request For Quote Information

Company Name: \_\_\_\_\_

Contact Name: \_\_\_\_\_

Email: \_\_\_\_\_

Phone #: \_\_\_\_\_

State: \_\_\_\_\_ Quantity Needed: \_\_\_\_\_

Lead Time Needed: \_\_\_\_\_

Additional Notes:

Material: \_\_\_\_\_

Options

- Stainless Steel  
C1018 Carbon Steel  
C1045 Carbon Steel

Plastic (UHMW, Nylon, Etc...)

Hardened Teeth (Yes or No)